

# BENCHMARK<sup>TM</sup><sub>MC</sub>

## PNEUMATIC COIL ROOFING NAILER



5 Year Limited Warranty



**READ ALL INSTRUCTIONS BEFORE FIRST USE.  
KEEP THIS MANUAL FOR FUTURE REFERENCE.  
KEEP AWAY FROM CHILDREN.**



**WEAR CSA APPROVED  
EYE PROTECTION**



**WEAR EAR  
PROTECTION**



**WEAR A  
FACE MASK**

## PRODUCT SPECIFICATIONS

PNEUMATIC COIL ROOFING NAILER	
Maximum working pressure	120 PSI
Air inlet size	1/4" NPT
Activation mode	contact actuation
Fastener Type	Round Head Roofing Nails 3/4" to 1-3/4" Long, flat wire welded
Magazine Capacity	120pcs
Magazine angle	15°
Working pressure	70-110 PSI
Recommended hose	1/4" (6.35mm) or 3/8" (9.5mm)
Air Inlet	¼" NPT
Recommended lubricant	white mineral oil 16#
Average Air Consumption	2 CFM @ 90 PSI
Weight (without fasteners)	6.1lb (2.8kg)

\*Please note (where the ¼" NPT connector is not already installed on the tool) your tool may be shipped with a black plastic cap installed in the air inlet. Pry the cap out prior to installing the ¼" NPT connector.

### NEED ASSISTANCE?

Call us on our toll- free customer support line:

1-866-349-8665 (Monday through Friday 9am – 5pm Eastern Standard Time)

- Technical questions
- Replacement parts
- Parts missing from package

 Note these instructions pertain to the tool only. Please refer to your compressors operator's manual and follow the manufacturers instructions.

**TABLE OF CONTENTS**

Product Specifications ..... 1  
Table of Contents ..... 2  
Safety Guidelines ..... 3-6  
Symbols ..... 7  
Tool Specific Warnings ..... 8  
Know Your Pneumatic Coil Roofing Nailer ..... 9  
Assembly and Operating ..... 10-14  
Maintenance ..... 15  
Troubleshooting ..... 15-16  
Exploded View ..... 17  
Parts List ..... 18-21  
Warranty..... 22

## SAFETY GUIDELINES

### **WARNING:**

This manual contains information that relates to PROTECTING PERSONAL SAFETY and PREVENTING EQUIPMENT PROBLEMS. It is very important to read this manual carefully and understand it thoroughly before using the product. The symbols listed below are used to indicate this information.

 **DANGER! Potential hazard that will result in serious injury or loss of life.**



 **WARNING! Potential hazard that could result in serious injury or loss of life.**



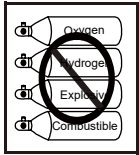

 **CAUTION! Potential hazard that may result in moderate injury or damage to equipment.**

**Note** - The word " Note " is used to inform the reader of something he / she needs to know about the tool.

### **PERSONAL SAFETY**

These precautions are intended for the personal safety of the user and others working with the user. Please take time to read and understand them.

SYMBOL	MEANING
	<ul style="list-style-type: none"> <li>• <b>Do not use oxygen or any other combustible or bottled gas to power air-powered tools.</b> Failure to observe this warning can cause explosion and serious personal injury or death. Use only the compressed air to power the air-powered tools. Use a minimum of 25' (7.6 m) of hose to connect the tool to the compressor. Failure to comply will result in serious injury or loss of life.</li> </ul> 
	<ul style="list-style-type: none"> <li>• <b>Risk of electric shock:</b> Do not expose a compressor to rain. Store it indoors. Disconnect the compressor from power source before servicing. Compressor must be grounded. Do not use grounding adaptors.</li> </ul>
	<ul style="list-style-type: none"> <li>• <b>Risk of personal injury:</b> Do not direct compressed air from the air hose towards the user or other personnel.</li> </ul>

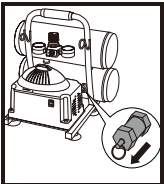
SYMBOL	MEANING
	<ul style="list-style-type: none"> <li>• <b>Risk of inhalation:</b> Never directly inhale the air produced by the compressor.</li> </ul>
	<ul style="list-style-type: none"> <li>• <b>Risk of bursting:</b> Do not adjust the pressure switch or safety valve for any reason. They have been pre-set at the factory for this compressor's maximum pressure. Tampering with the pressure switch or the safety valve may cause personal injury or property damage.</li> </ul>
	<ul style="list-style-type: none"> <li>• <b>Risk of burns.</b> The pump and the manifold generate high temperatures. In order to avoid burns or other injuries, do not touch the pump, the manifold, or the transfer tube while the compressor is running. Allow the parts to cool down before handling or servicing. Keep children away from the compressor at all times.</li> </ul>
	<ul style="list-style-type: none"> <li>• <b>Risk of bursting:</b> Make sure the regulator is adjusted so that the compressor outlet pressure is set lower than the maximum operating pressure of the tool. Before starting the compressor, pull the ring on the safety valve to make sure the valve moves freely. Drain water from tank after each use. Do not weld or repair tank. Relieve all pressure in the hose before removing or attaching accessories.</li> </ul> 

 **DANGER!**

- Keep children away from the work area. Do not allow children to handle power tools.
- Do not use this tool in the presence of flammable liquids or gases. Sparks that are created during use may ignite gases.
- Keep air hose away from heat, oil, and sharp edges. Check air hose for wear before each use and ensure that all connections are proper.
- Always ensure that the workpiece is firmly secured leaving both hands free to control the tool.
- Always ensure that the tool has stopped before putting it down after use, for safety purposes and to prevent possible damage to the tool/user.
- Keep proper footing at all times in order to ensure correct balance.
- Always assume that the tool contains fasteners.
- Do not point the tool toward yourself or anyone else.



## **WARNING!**

- Do not allow unskilled or untrained individuals to operate the air tool.
- Do not use the tool for any task other than that it is designed to perform.
- Locate the compressor in a well-ventilated area for cooling, and a minimum of 12" (31 cm) away from the nearest wall.
- Protect the air hose and the power cord from damage and puncture. Inspect them for weak or worn spots every week and replace them if necessary.
- Always wear hearing protection when using the air compressor. Failure to do so may result in hearing loss.
- Do not carry the compressor while it is running.
- Do not operate the compressor if it is not in a stable position.
- Do not operate the compressor on a rooftop or an elevated position that could allow the unit to fall or be tipped over.
- Always replace a damaged gauge before operating the unit again.
- Do not connect the tool to a compressed air source with a pressure output that is higher than 120psi.



## **CAUTION!**

- Always ensure that the tool has stopped before disconnecting the air supply.
- Do not wear watches, rings, bracelets, or loose clothing when using any air- powered tool.
- Do not overload the tool. Allow the tool to operate at its optimum speed for maximum efficiency.
- Do not use a tool that is leaking air, that has missing or damaged parts, or that requires repairs. Verify that all screws are securely tightened.
- For optimal safety and tool performance, inspect the tool before every usage, in order to ensure free movement of the trigger, safety mechanisms, and springs. Always keep your air tool clean and lubricated. Daily lubrication is essential to avoid internal corrosion and possible failures.
- Ensure the floor is not slippery and wear non-slip shoes. Floors should be kept clean and clear.
- Always follow all workshop safety rules, regulations, and conditions when using the tool and keep the work area clean.
- Carry the tool by the handle only, keeping fingers away from the trigger. Do not carry the tool by the hose, magazine, or any other parts.
- Do not use the tool near or below freezing point, as doing so may cause tool failure. Do not store the tool in a freezing environment to prevent ice formation on the tools operating valves, as doing so may cause tool failure.
- Handling and storage of oil: Use with adequate ventilation. Avoid contact of oil with eyes, skin, and clothing. Avoid breathing spray or mist. Store in a tightly closed container in a cool, dry, well-ventilated area free from Incompatible substances.
- Tripping hazard. The air hose may become a tripping hazard when it is placed in the work area. Use care when walking in the work area.



**CAUTION!**

- Disconnect tool from the air supply and turn off the compressor before performing any maintenance or changing accessories, when clearing a jammed fastener, when the tool is not in use, when it is being handed to another person, and when it is left unattended. Failure to comply may result in moderate injury or damage to equipment.

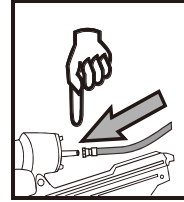

- Use safety goggles and ear protection: Wear safety glasses with side shields when operating the tool/ compressor and verify that others in the work area are also wearing safety glasses. Safety glasses must conform to American National Standards Institute (ANSI Z87. 1) requirements and must provide protection from flying particles from the front and the sides.

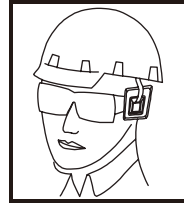

Air-powered tools are loud, and the sound can cause hearing damage.

Always wear ear protection to prevent hearing damage and loss. Failure to comply may result in moderate injury.

**Note:** Recycle unwanted materials rather than disposing of them as waste. Sort the tools, hoses, and packaging in specific categories and take to the local recycling centre or dispose of in an environmentally safe way.

## SYMBOLS

**⚠️ WARNING:** Some of the following symbols may appear on the nailer. Study these symbols and learn their meaning. Proper interpretation of these symbols will allow for more efficient and safer operation of this tool.

V	Volts		Three-phase alternating current with neutral
A	Amperes		
Hz	Hertz		Direct current
W	Watts		No load speed
kW	Kilowatts		Alternating or direct current
$\mu\text{F}$	Microfarads		Class II construction
L	Litres		Splash-proof construction
kg	Kilograms		Watertight construction
H	Hours		Protective grounding at terminal, Class I tools
$\text{N}/\text{cm}^2$	Newtons per square centimetre	.../min	Revolutions or reciprocations per minute
Pa	Pascals		Diameter
Min	Minutes		Off position
S	Seconds		Directional arrow
~ or AC	Alternating current		Warning symbol
$3 \sim$	Three-phase alternating current		Wear your safety glasses



## **TOOL SPECIFIC WARNINGS**



**DANGER** Potential hazard that will result in serious injury or death.

- Do not disconnect or reconnect the air hose with the tool pressed or with a fastener in the guide. The tool may fire when it is reconnected to the air supply.



**WARNING** Potential hazard that could result in serious injury or death.

- Keep hands and other parts of the body away from the nail guide during use. Keep hands and feet and all other parts of the body at least 8" (20cm) away from the firing head.
- Objects in the workpiece can cause serious injury if they cause the fasteners to be deflected or to be driven away from the point of entry.
- Do not drive fasteners on top of a fastener. The fastener may ricochet, causing serious personal injury.
- Do not drive fasteners on scaffoldings, ladders, or such similar construction.
- Use only fasteners of the proper size and gauge, as specified in this manual.
- Do not drive fasteners close to the edge of the workpiece. The workpiece may split which could allow the fastener to fly free or ricochet and cause serious personal injury.

**KNOW YOUR  
PNEUMATIC COIL ROOFING NAILER**

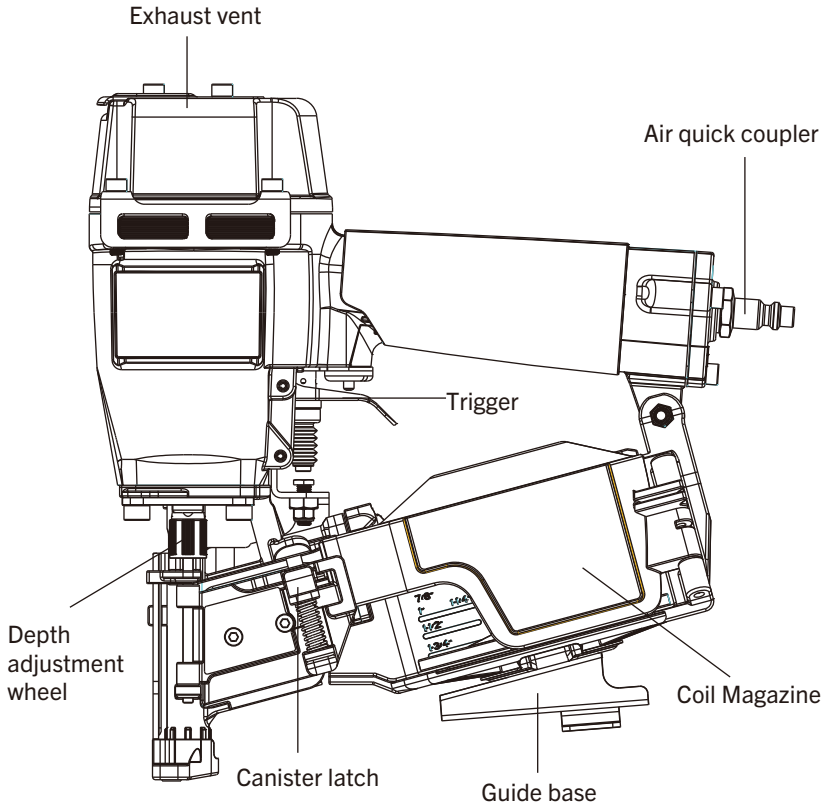

## ASSEMBLY AND OPERATING

### Acceptable Fasteners



**WARNING: The use of any other types of fasteners will cause the tool to jam. Failure to comply could lead to serious injury or loss of life.**

Nail length:  $\frac{3}{4}$ -1- $\frac{3}{4}$ "; Magazine capacity: 120pcs

### Description / Features

- Uses 15-degree 19mm ( $\frac{3}{4}$ " ) to 45mm (1- $\frac{3}{4}$ " ) wire collated roofing nails.
- Has steel contact safety with dual carbide inserts for less wear.
- Features soft grip for comfort and control.
- Delivers the power to consistently drive nails in the toughest applications.
- Big loading capacity magazine will fasten a full bundle of shingles without reloading.

### FIRING MODES

The Nailer has two firing modes: Single-Sequential actuation for single firing, or Contact / bump actuation for repetitive, fast firing of nails.

Each mode requires a different method of operation:

**Single Firing:** To operate the tool in this manner, first position the Workpiece Contact (nose of tool) on the work surface, **WITHOUT PULLING THE TRIGGER.** Depress the Workpiece Contact until the Workpiece contact (nose of tool) touches the work surface and then pull the trigger to drive a fastener. Do not press the tool against the work with extra force. Instead allow the tool to recoil off the work surface to avoid a second, unwanted fastener. Remove your finger from the trigger.

**Contact or Bumping actuation mechanism:** To operate the tool in this manner, hold the tool with the Workpiece Contact (nose of tool) pointing towards but not touching the work surface. Pull the trigger and then tap (bump) the Workpiece Contact against the work surface using a bouncing motion. Each depression of the Workpiece Contact will cause a fastener to be driven.

### COMPATIBLE COMPRESSORS

#### GUIDELINES FOR PROPER USE AND OPERATION

Be sure to use a proper air compressor with air powered tools. The compressor should be able to supply a minimal air deliver of 2 CFM @ 90 PSI to ensure the compressor can run continuously with the tool.

Air Compressor Size & Power	1 1/2–2 HP	2 1/2 HP	3+ HP
4 - 5 Gallons	Light duty and intermittent use	Light duty and intermittent use	Light duty and intermittent use
6 - 11 Gallons	Light duty and intermittent use	Medium duty and intermittent use	Medium duty and intermittent use
15+ Gallons	Medium duty and intermittent use	Heavy-duty and continuous use	Heavy duty and continuous use

Wood density	Nail size	Compressor air pressure
>0.6g/cm <sup>3</sup>	<1/2" (38 mm) T nails	90 psi
	≥1/2" (38 mm) T nails	110 psi
≤0.6g/cm <sup>3</sup>	<1/2" (38 mm) T nails	70 psi
	≥1/2" (38 mm) T nails	100 psi

## AIR SYSTEM

Always use clean, dry, regulated, compressed air at 5 to 7.5 bar (70 To 110 PSI). Do not exceed the maximum or minimum pressures. Operating the tool at the wrong pressure (too low or too high) will cause excessive noise or rapid wear of tool.

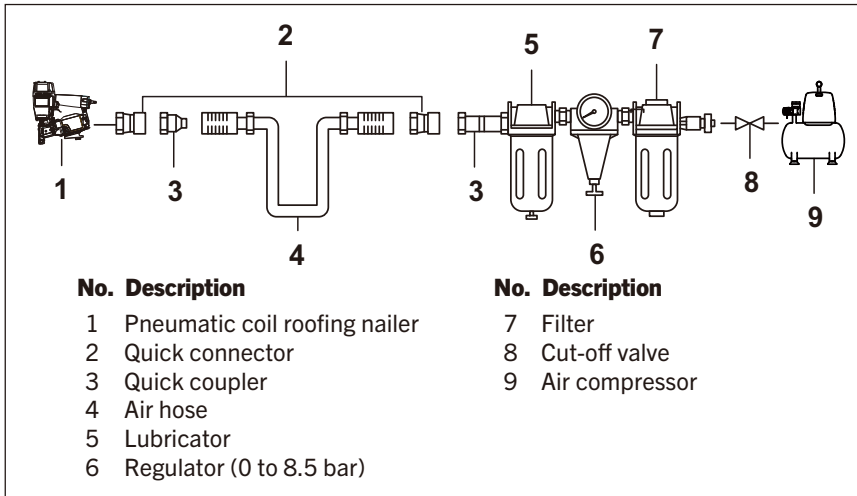

**PREPARING THE TOOL FOR USE**

Please read and observe these operating instruction before using the tool. Basic safety measures should always be strictly followed to protect against damage to the equipment and personal injury to the user or other people working in the vicinity of operation.

**Connection to the compressed air system**

- Ensure that the pressure supplied by the compressed air system does not exceed the maximum allowable pressure of the tool. Set the air pressure initially to the lower value of the recommended allowable pressure (see Product Specifications).
- Empty the magazine to prevent a fastener from firing.
- Connect the tool to the compressed air supply using a suitable pressure hose equipped with quick-action connectors.
- Check for proper functioning by applying the nose of the tool to a piece of wood and actuating the trigger once or twice.
- Load nails into tool.

**Loading nails**

**⚠ DANGER! Potential hazard that will result in serious injury or loss of life.**

- Disconnect the tool from the compressed air source before loading nails.
- Do not point the tool towards the operator or other people while changing nails.
- Do not hold the tool with the trigger pressed while changing the nails. Failure to comply will lead to serious injury or loss of life.

1. Disconnect the tool (1) from the air supply (2) (fig A).

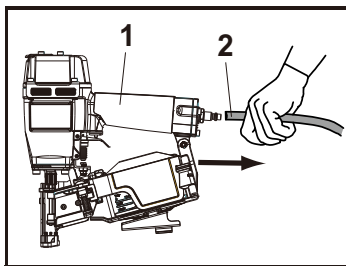

fig A

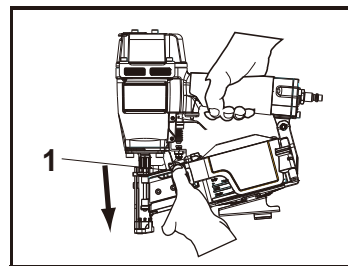

fig B

2. Take hold of the nailer with one hand and use the other hand to press the Canister latch (1) down (fig B), then open to the left and open the magazine to the right (fig C).

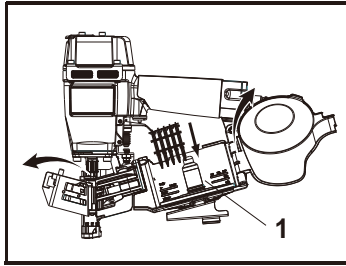

fig C

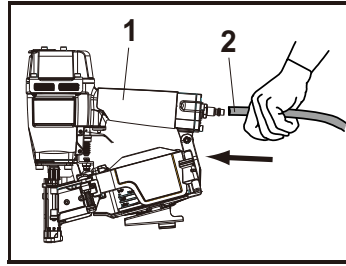

fig D

3. Insert a strip of nails into the coil magazine. Ensure the points of the nails are facing down. Be sure to insert the heads of the nails into the channel. Close the coil magazine and push close the magazine latch (1) until it locks into place. The tool is now ready for use (fig C).
4. Plug in compressor, turn it on set the pressure regulator to 90 psi, attach one end of the air hose to the compressor and the other end of the air hose (1) to the tool (2). Use plumber's tape to avoid air leak (fig D).
5. Test the driving depth using a sample piece of wood before working on the workpiece. If the nails are being driven too deep or not deep enough, adjust the regulator in order to provide more or less air pressure, as required.

**NOTE!** Only those fasteners specified under specifications may be used. When filling the magazine, hold the tool so that the nose is not pointing towards the operator or any other person or animals.

### **Adjusting nail depth**

For varying materials, the nail depth can be tool- free adjusted with the depth adjustment wheel.

### **Increasing nail depth**

Push the depth adjustment wheel down, while at the same time, turning the depth adjustment wheel counter- clockwise (with the discharge area of the tool facing away from the operator).

### **Decreasing nail depth**

Push the depth adjustment wheel down, while at the same time, turning the depth adjustment wheel clockwise (with the discharge area of the tool facing away from the operator).

Apply the tool to a work piece and actuate the trigger.

Check whether the fastener has been driven into the work piece in accordance with the requirements, if it is not, then adjust the pressure of the regulator on the compressor accordingly.

**WARNING: Avoid triggering the fastener driving tool if the magazine is empty.**

Any defective or improperly functioning fastener driving tool must immediately be disconnected from the compressed air supply and passed to a specialist for inspection.

**NOTE:**

- Always handle nails and package carefully. If nails are dropped, collating plastic may be broken.
- After nailing:
  - 1) Disconnect air hose from the nailer.
  - 2) Remove all nails from the nailer.
  - 3) Supply 5-10 drops of pneumatic tool lubricant into the air inlet plug on the nailer.
  - 4) Open the petcock on the air compressor tank to drain any moisture.

**Filling the magazine**

Only those fasteners specified under product specification may be used when filling the magazine, hold the tool so that the muzzle is not pointing towards the operator or any other person or animals.

**Clearing a jammed nail****WARNING: Potential hazard that could result in serious injury or loss of life.**

- Disconnect the air hose from the tool and remove the non-jammed nails from the tool before clearing a jammed nail.
- The nails are under pressure and failure to comply could cause them to be fired out of the tool causing serious injury.
- Use pliers or any appropriate tool to remove the jammed nails.
- Reload the nails into the tool magazine.
- Reconnect the air hose to the tool's air inlet.
- Test fire 3 to 5 nails into a piece of scrap wood in order to ensure a proper operation.

**WARNING: Potential hazard that could result in serious injury or loss of life.**

- Do not point the tool towards the operator or other people. Serious personal injury could result if these instructions are not followed.

**STORAGE**

If it is necessary to store the tool for an extended period of time, apply a generous amount of lubrication before storing. The tool should be allowed to run for approximately 30 seconds after lubricating in order to ensure that the lubrication is uniformly distributed throughout the tool.

## MAINTENANCE

**Note:** Do not store the tool anywhere temperatures will fall below freezing.



### **DANGER!**

Disconnect the tool from the air compressor before maintenance/service, adjusting, cleaning jams, reloading, and when it is not in use. Repairs must be performed by a qualified service technician only. Failure to comply will lead to serious injury or loss of life.

Lubrication: if the tool and the compressor are not equipped with an in-line lubrication system, place up to 6 drops of pneumatic tool oil into the air inlet before each use or after every 2 hours of continuous use, depending on the characteristics of the workpiece and type of fastener used.

Air operated tools must be inspected periodically, and worn or broken parts must be replaced to ensure that the tools are operating safely and efficiently. Inspect and replace worn or damaged O-rings, seals, etc. Tighten all screws and caps frequently in order to help prevent personal injury. Keep the magazine of the tool clean and free of any dirt or abrasive particles.

## TROUBLESHOOTING



### **DANGER! Potential hazard that will result in serious injury or loss of life.**

If any of the following symptoms appear while the tool is in use, turn it off and disconnect it from the air supply immediately. Failure to comply will lead to serious injury or loss of life.

Disconnect the tool from the air supply before making any adjustments. Repairs must be performed by a qualified service technician only.

**The following chart lists common issues and solutions. Please read it carefully and follow all instructions carefully.**

SYMPTOM	POSSIBLE	SOLUTIONS
Air leak near top of tool or in trigger area	<ol style="list-style-type: none"> <li>1. O-rings in trigger valve are damaged.</li> <li>2. Trigger valve heads are damaged.</li> <li>3. Trigger valve stem, seal, or O-rings are damaged.</li> </ol>	<ol style="list-style-type: none"> <li>1. Check and replace O-ring.</li> <li>2. Check and replace.</li> <li>3. Check and replace trigger valve stem, seal, or O-ring</li> </ol>
Air leak near bottom of tool.	<ol style="list-style-type: none"> <li>1. Loose screws.</li> <li>2. Worn or damaged O-ring or bumper.</li> </ol>	<ol style="list-style-type: none"> <li>1. Tighten screws.</li> <li>2. Check and replace O-ring or bumper.</li> </ol>
Air leak between body and cylinder cap.	<ol style="list-style-type: none"> <li>1. Loose screws.</li> <li>2. Worn or damaged O-ring or seals.</li> </ol>	<ol style="list-style-type: none"> <li>1. Tighten screw.</li> <li>2. Check and replace O-ring or bumper.</li> </ol>



SYMPTOM	POSSIBLE	SOLUTIONS
Blade driving fastener too deep.	<ol style="list-style-type: none"> <li>1. Worn bumper</li> <li>2. Air pressure is too high.</li> </ol>	<ol style="list-style-type: none"> <li>1. Replace bumper</li> <li>2. Adjust the air pressure.</li> </ol>
Tool does not operate well: can not drive fastener or operate sluggishly.	<ol style="list-style-type: none"> <li>1. Inadequate air supply.</li> <li>2. Inadequate lubrication</li> <li>3. Worn or damaged O-rings or seals.</li> <li>4. Exhaust port in cylinder head is blocked.</li> </ol>	<ol style="list-style-type: none"> <li>1. Verify adequate air supply.</li> <li>2. Place 2 or 6 drops of oil into air inlet.</li> <li>3. Check and replace O-rings or seal.</li> <li>4. Replace damaged internal parts.</li> </ol>
Tool skips fasteners.	<ol style="list-style-type: none"> <li>1. Worn bumper or damaged spring.</li> <li>2. Dirt in front plate.</li> <li>3. Dirt or damage prevents fasteners from moving freely in magazine.</li> <li>4. Worn or dry O-ring on piston or lack of lubrication.</li> <li>5. Cylinder cover seal leaking.</li> </ol>	<ol style="list-style-type: none"> <li>1. Replace bumper or pusher spring.</li> <li>2. Clean drive channel on front plate.</li> <li>3. Magazine needs to be cleaned.</li> <li>4. O-ring need to be replaced. And lubricate.</li> <li>5. Replace sealing washer.</li> </ol>
Tool jams.	<ol style="list-style-type: none"> <li>1. Incorrect or damaged fasteners.</li> <li>2. Damaged or worn driver guide.</li> <li>3. Magazine or nose screw loose.</li> <li>4. Magazine is dirty.</li> </ol>	<ol style="list-style-type: none"> <li>1. Change and use correct fastener.</li> <li>2. Check and replace the driver.</li> <li>3. Tighten the magazine.</li> <li>4. Clean the magazine.</li> </ol>

## EXPLODED VIEW

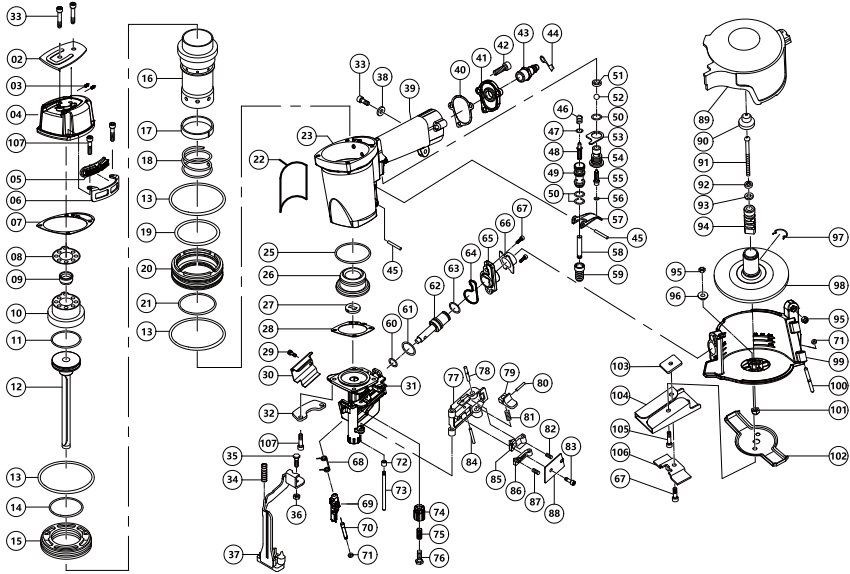

**PARTS LIST**

**⚠ WARNING:** When servicing, use only original equipment replacement parts. The use of any other parts may create a safety hazard or cause damage to the tool. Any attempt to repair or replace electrical parts on this tool may create a safety hazard unless repairs are performed by a qualified technician. For more information, call the Toll-free Helpline, at 1-866-349-8665.

Always order by part number.

Key #	Part #	Part Name	Quantity
1	/	/	/
2	03.04.21.058-01	Exhaust cover	1
3	03.04.05.072	Bolt M5x6	2
4	03.04.28.116	Cylinder cover	1
5	03.04.17.151	Protector	2
6	03.04.16.144	Body guard	2
7	03.04.07.149	Cylinder washer	1
8	03.04.07.150	Trigger valve wasner	1
9	03.04.40.113	Seal plug	1
10	03.04.39.08.014	Trigger valve assembly	1
11	03.04.01.033	O-ring 30.5x3.5	1
12	03.04.39.01.224	Piston	1
13	03.04.01.086	O-ring 65x2	3
14	03.04.01.085	O-ring 41.5x2.4	1
15	03.04.19.215	Upper collar	1
16	03.04.27.072	Cylinder	1
17	03.04.19.217	Cylinder sealing washer	1
18	03.04.34.087	Cylinder spring	1
19	03.04.01.094	O-ring 56x2.4	1
20	03.04.19.216	Lower collar	1
21	03.04.01.095	O-ring 47x2.4	1
22	05.04.33.1126	Label	1
23	03.04.26.249-01	Gun body	1
24	/	/	/
25	03.04.01.096	O-ring 43.5x2.65	1
26	03.04.06.092	Bumper	1
27	03.04.19.218	Sealing washer	1
28	03.04.07.151	Gun body washer	1
29	03.04.05.402	Bolt M5x8	2

Key #	Part #	Part Name	Quantity
30	03.04.02.155	Guard	1
31	03.04.08.199	Nose	1
32	03.04.17.144	Nose guard	2
33	03.04.05.023	Bolt M5x25	3
34	03.04.36.295	Safety shelf spring	1
35	03.04.05.372	Bolt M5x16	1
36	03.04.05.738-01	Nut M5	1
37	03.04.39.04.058	Safety shelf assembly	1
38	03.04.19.236	Washer d=5	1
39	03.04.29.230	Gun body grip	1
40	03.04.07.152	End cover washer	1
41	03.04.11.097-03	End cover	1
42	03.04.05.405	Bolt M5x20	3
43	03.04.40.170	Air inlet plug	1
44	03.04.29.158	Air inlet plug case	1
45	03.04.05.197	Pin 3x30	2
46	03.04.34.088	Plunger spring	1
47	03.04.01.115	O-ring 3.55x2	1
48	03.04.15.110	Plunger	1
49	03.04.32.115	Valve bushing	1
50	03.04.01.301	O-ring 11.8x1.5	3
51	03.04.19.059-01	Rectangle washe	1
52	03.04.40.112	Ball	1
53	03.04.25.146	Valve bushing fix plate	1
54	03.04.32.059	Trigger valve seat	1
55	03.04.15.046	Trigger valve pole	1
56	03.04.01.035	O-ring 2.8x1.8	1
57	03.04.03.018-03	Trigger	1
58	03.04.15.112	Pushing lever	1
59	03.04.29.144	Pushing lever case	1
60	03.04.01.059	O-ring 8.75x1.8	1
61	03.04.40.422	O-ring 14.2x1.9	1
62	03.04.40.413	Feed piston	1
63	03.04.01.298	O-ring 11.2x1.8	1
64	03.04.19.220	Feed piston sealing washer	1
65	03.04.04.170	Feed piston cover	1
66	03.04.29.164	Lockout bushing	1

Key #	Part #	Part Name	Quantity
67	03.04.05.403	Bolt M5x10	3
68	03.04.24.032	Feeder spring	1
69	03.04.33.018	Feeder	1
70	03.04.31.135	Feeder pin	1
71	03.04.29.222	Feeder case	2
72	03.04.29.223	Movable cover case	1
73	03.04.31.136	Movable cover pin	1
74	03.04.29.180	Adjust knob	1
75	03.04.36.296	Adjust spring	1
76	03.04.05.736	Bolt M6x18	1
77	03.04.13.184	Movable cover	1
78	03.04.31.137	Lock pin	1
79	03.04.10.065	Guide lock	1
80	03.04.05.190	Pin 3x12	1
81	03.04.36.297	Spring	1
82	03.04.36.298	Stopper spring	1
83	03.04.05.420	Bolt M4x10	2
84	03.04.05.349	Pin 3x28	1
85	03.04.17.145	Main nail stopper	1
86	03.04.17.146	Nail stopper	1
87	03.04.36.299	Sub stopper spring	1
88	03.04.02.156	Nail guide cover	1
89	03.04.40.414	Magazine cover	1
90	03.04.04.171	Holder cap	1
91	03.04.05.124	Bolt M4x50	1
92	03.04.05.262-03	Spring washer 4	1
93	03.04.05.743	Washer d=4	1
94	03.04.15.113	Holder shaft	1
95	03.04.05.738-01	Nut M5	3
96	03.04.29.221	Sleeve	2
97	03.04.34.089	Steel wire spring	1
98	03.04.40.415	Nail holder	1
99	03.04.40.416	Magazine	1
100	03.04.31.138	Magazine cover pin	1
101	03.04.05.737-01	Nut M4	1
102	03.04.02.157	Magazine guard	1
103	03.04.17.147	Plate nut	1

Key #	Part #	Part Name	Quantity
104	03.04.32.164	Guide base	1
105	03.04.05.404	Bolt M5x14	2
106	03.04.17.148	Shingle guide	1
107	03.04.05.408	Bolt M5x22	8

## **WARRANTY**

### **BENCHMARK WARRANTY**

If this Benchmark tool fails due to a defect in material or workmanship within five years from the date of purchase, return it to any Home Hardware store with the original bill of sale for exchange. 3-year warranty for the battery and charger. This warranty does not include expendable parts including but not limited to blades, brushes, belts, light bulbs. This warranty covers defects in material or workmanship only. It does not cover normal wear and tear, failure due to abuse/misuse, or defects caused by careless or accidental mishandling. If this Benchmark product is used for commercial or rental purposes, this warranty does not apply.

# PNEUMATIC COIL ROOFING NAILER



\*5 year limited warranty on tool

**BENCHMARK**<sup>TM</sup><sub>MC</sub>

**BENCHMARK TOOLS CANADA**

ST. JACOBS, ONTARIO N0B 2N0

© 2021 Home Hardware Stores Limited

**CUSTOMER SERVICE/TECH SUPPORT**

1-866-349-8665

**1282 309**

Made in China



\*This Benchmark<sup>TM</sup> product carries a five (5) year LIMITED warranty against defects in workmanship and materials. The charger and batteries carry a three (3) year LIMITED warranty. See Owner's Manual for full details.

**READ ALL INSTRUCTIONS BEFORE FIRST USE.  
KEEP THIS MANUAL FOR FUTURE REFERENCE.  
KEEP AWAY FROM CHILDREN.**



**WEAR CSA APPROVED  
EYE PROTECTION**



**WEAR EAR  
PROTECTION**



**WEAR A  
FACE MASK**